

G3 Illuminated Remote Run Button Kit

3A0528E

ENG

Used for remote indication of pump state and to initiate a manual lube operation. For professional use only.

Kit Nos.*: 12 Volt - 571030, 571032; 24 Volt - 571031, 571033

*All Kits rated IP65.



Important Safety Instructions

Read all warnings and instructions in this manual and the G3 Pump instruction manual included with your unit. Save these instructions.

Parts Included in Kits

Item No.	Description	Qty
1	BUTTON, push, 12 V, Kits 571030, 571032; 24 V, Kits 571031, 571033	1
2	CONNECTOR, quick	4
3	LABEL, run	1
4	HARNESS, wiring, M12 to bare wire, models 571032, 571033	1
5	O-RING	1

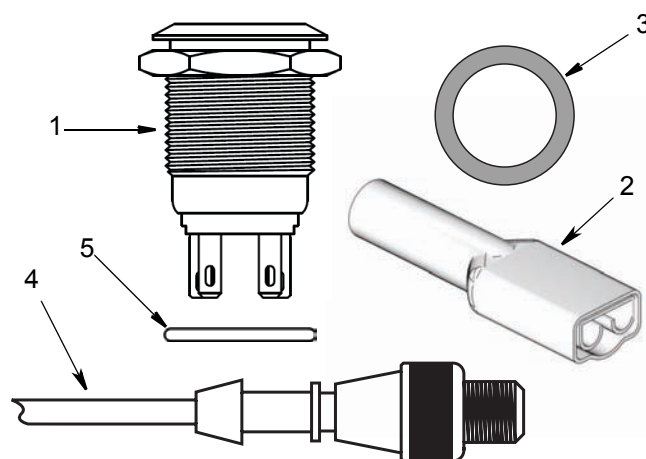

Instructions

1. Disconnect power source to G3 pump.
2. Drill hole in panel or plate. (See illustration of the right for cutout dimension. Maximim panel thickness is 0.472 in./12.0 mm).
3. Remove lock nut (a) from button (1). Install o-ring (5) (FIG. 1).

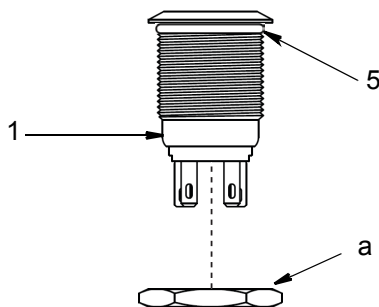

FIG. 1

4. For illuminated remote manual output installations, connect end of wiring harness (4) to connector location on G3 pump identified with symbol to the right. (See wiring diagram, page 4.)



NOTE: For 5-wire power cable installations (Graco Part No. 123750, sold separately), connect end of wiring harness to CPC power input. (See wiring diagram, page 4.)

5. Route and secure wire harness (4) from G3 installation location. Trim excess wire length from wiring harness (4).
6. Strip approximately 1" of harness jacket and 1/4" of conductor back. Install quick connectors (2) to wires (4) using a crimp connector.
7. Insert end of wires (4) from the back side of panel or plate, through lock nut (a) and through hole in panel or plate (c) (FIG. 2). (Note location of o-ring (5) for correct installation.)

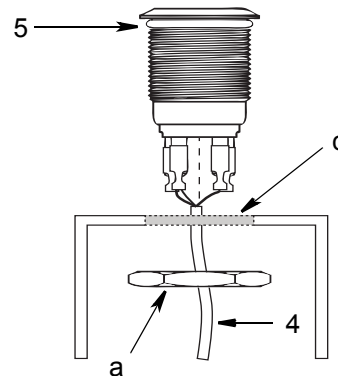

FIG. 2

8. Connect wiring harness (4) to button (1) . Refer to wiring diagram page 4.
9. Insert button through hole in panel or plate (b) and hand tighten lock nut (a) to secure button (1) in place.
10. Clean surface around outer edge of button (1). Position label (3) around button and adhere label to panel or plate.

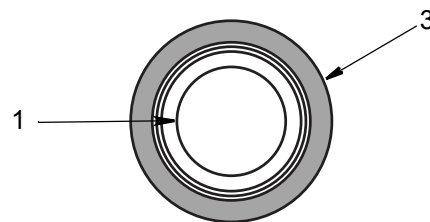
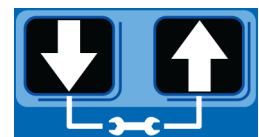

FIG. 3

Testing Installation

Illuminated Remote Manual Run

1. Power up G3 and enter Setup Mode by pressing both the UP and DOWN ARROW buttons together for 3 seconds.



2. Button illumination should cycle between green, yellow and red.
3. Press Reset button to exit test.



5-Wire CPC Power Cable

- 1. Power up G3 and enter Setup Mode by pressing both the UP and DOWN ARROW buttons together for 3 seconds.
- 2. Button will flash green.
- 3. Press Reset button exit test.



Testing Manual Run

Press remote run button and verify light turns green and unit has entered the lube cycle.

Validating Color Function

	Tri-Color Remote Illumination	Standard Remote Illumination
Unit in OFF Mode	Off	Off
Unit in ON Mode	Green	Green
Warning Condition	Yellow	Toggles On and Off once per second
Fault Condition	Red	Toggles On and Off once per second

Wiring Diagrams



Illuminated Remote Manual Output

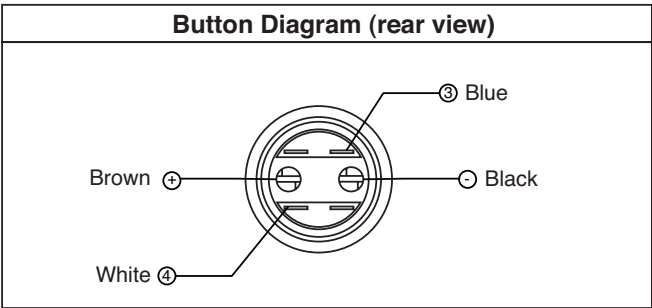
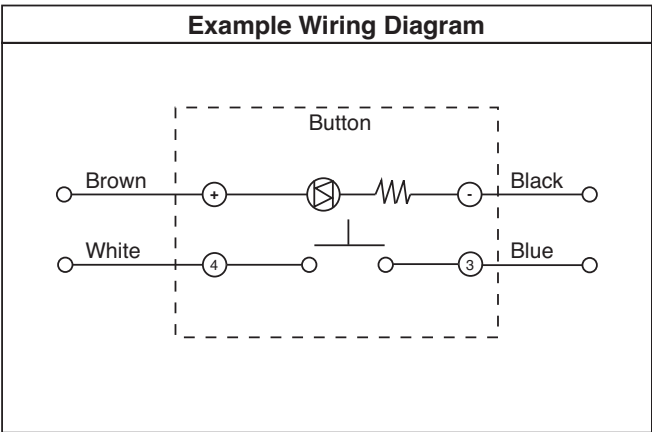
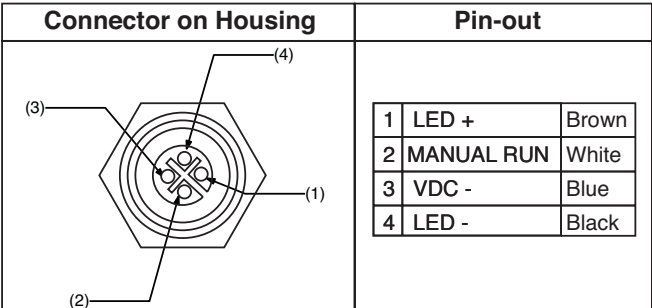

FIG. 4

5-Wire Power Cable (alternate installation)

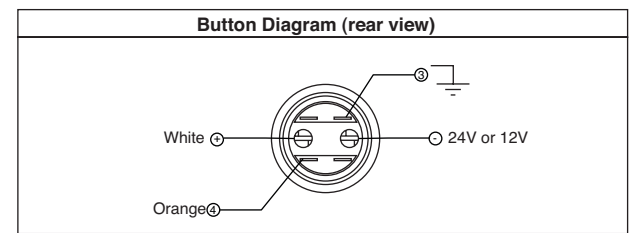
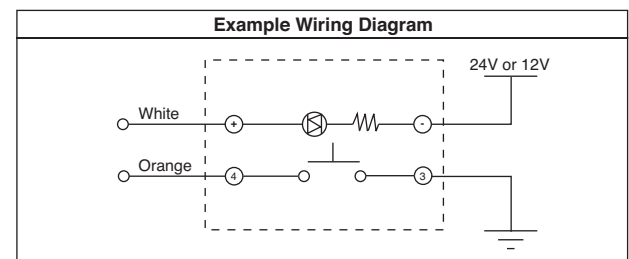
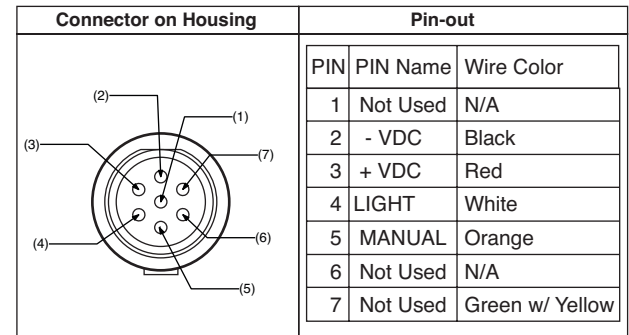

FIG. 5

All written and visual data contained in this document reflects the latest product information available at the time of publication. Graco reserves the right to make changes at any time without notice.

Original instructions. This manual contains English. MM 3A0528

Graco Headquarters: Minneapolis
International Offices: Belgium, China, Japan, Korea

GRACO INC. P.O. BOX 1441 MINNEAPOLIS, MN 55440-1441

Copyright 2010, Graco Inc. is registered to ISO 9001
www.graco.com
6/2010, revised 9/2010